

WDR
WIDE DYNAMIC RANGE



High Speed Shutter



Slow Speed Shutter

1•2•3 EASY INSTALLATION



Wall Type

Ceiling Type

620 NIGHT TVL
0.1 NIGHT LUX

×444 Total Zoom

- Samsung Camera Module
- Privacy Mask
- Digital Noise Reduction
- Sens-up : Intensified Low Light
- HLC : HighLight Compensation
- Design for Outdoor (weather & Vandal Resistant)
- ×36 Optical ×12 Digital
- Day & Night (ICR)
- Built-in Heater & Blower
- Sun-Shield

PT 9637C x444 Total Zoom / 620 (N) TVL / WDR / Digital Image Stabilizer / DNR / Day & Night / Outdoor Ceiling Type

PT 9637W x444 Total Zoom / 620 (N) TVL / WDR / Digital Image Stabilizer / DNR / Day & Night / Outdoor Wall Type

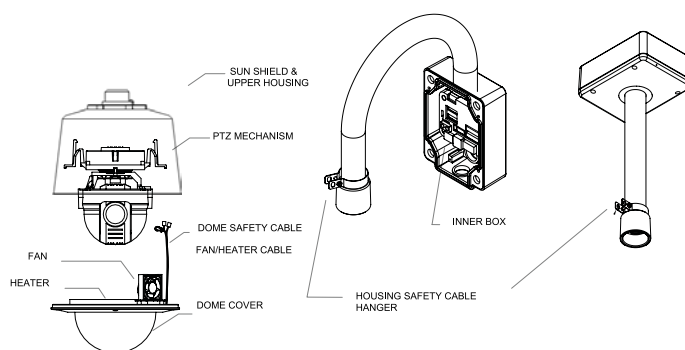

CAMERA FEATURES

- 1/4" Double Density Interline Transfer CCD
- ×444 Max. Zoom (×37 Optical, ×12 Digital)
- WDR (Wide Dynamic Range) function support.
- DIS (Digital Image Stabilizer) function support.
- Day & Night Function : ICR (IR Cut filter Removal)
- Various Focus Mode: Auto Focus / Manual Focus / Semi-Auto Focus.
- Independent or Global camera settings for each Preset locations.

POWERFUL PAN/TILT FUNCTIONS

- Max. 360°/sec. high speed Pan/Tilt Motion
- Using Vector Drive Technology, Pan/Tilt motions are accomplished in the shortest path. As a result, time to target view is reduced dramatically and the video on the monitor is very natural to watch.
- Ultra low speed (0.05°/sec.) enables operator to locate camera to desired target view with accuracy and ease.
- Zoom-proportional pan/tilt speed helps operator to move the camera easily.

PRESET, PATTERN, SCAN, GROUP, SCHEDULE AND MORE

- MAX. 127 Presets are assignable. All of them have independent characteristics such as White Balance, Auto Exposure, Label, Alarm Input/Output and so on.
- Max. 8 set of Scan can be stored. This enables to move camera repetitively between two preset positions with designated speed.
- Max. 4 of Patterns can be recorded and played back. This enables to move camera to follow any trajectory operated by joystick as closely as possible.
- Max. 8 set of Group action can be stored. This enables to move camera repetitively with combination of Preset or Pattern or Scan. A Group is composed of max. 20 entities of Preset/Pattern/Scans.
- 7 rules of Schedule can be assigned by day and time. Appropriate actions (such as Home, Preset, Group, Pattern and Scan) can be defined for each rule. Also, it is possible to use Weekday and All days to simplify the rule.

PTZ (PAN/TILT/ZOOM) CONTROL

- With RS-485 communication, max. 255 of cameras can be controlled at the same time.
- Pelco-D/ Pelco-P/ Samsung protocol can be selected as a control protocol in the current version of firmware.

OSD (ON SCREEN DISPLAY) MENU

- OSD menu is provided to display the status of camera and to configure the functions interactively.

Specifications may change without a prior notice. All the images on the page are for illustrative purpose only, may not representing actual products. All the rights for the registered trademarks are reserved for their respectable owners. Not responsible for any typographical errors.

1•2•3 EASY INSTALLATION

1. Installing mount for PTZ and Terminal Setup

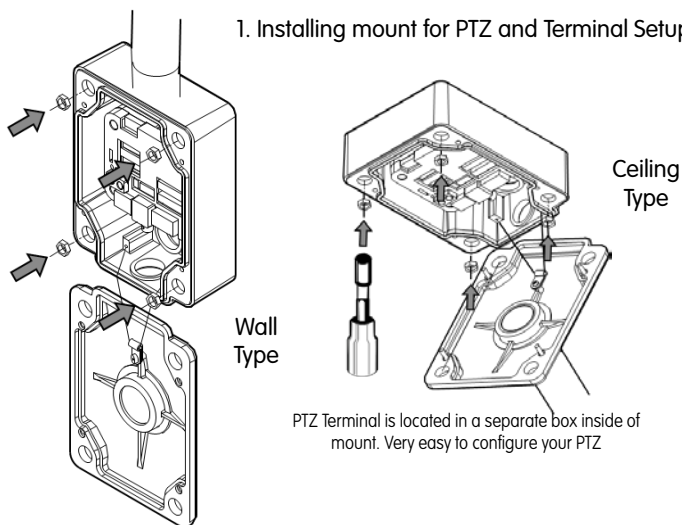

- The information such as Camera ID, Pan/Tilt/Zoom/Direction, Alarm Input & Output, date/time, current temperature and Preset can be displayed on screen.
- Each display item can be turned on or off independently.

ALARM I/O FUNCTIONS

- 8 alarm sensor inputs and 4 relay output are available.
- To reject external electric noise and shock perfectly, alarm sensor input is decoupled with photo coupler.
- The signal range of sensor input is from DC 5.0 to 12.0 volts to adopt various applications.
- If an external sensor is activated, camera can be set to move to the corresponding Preset position.
- Relay outputs can be assigned to work with a certain preset.

2. Connecting Dome Unit to the mount

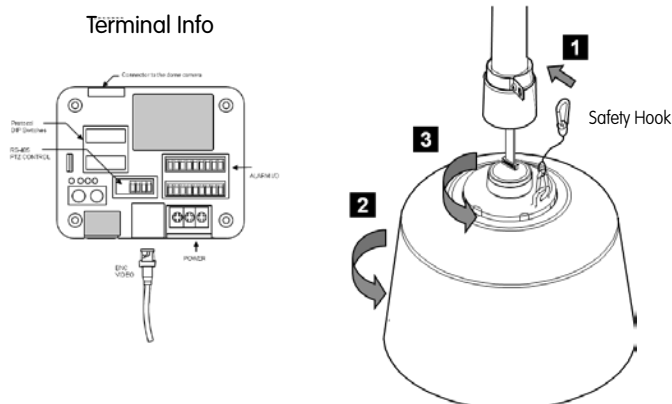

3. Installing a Camera Unit

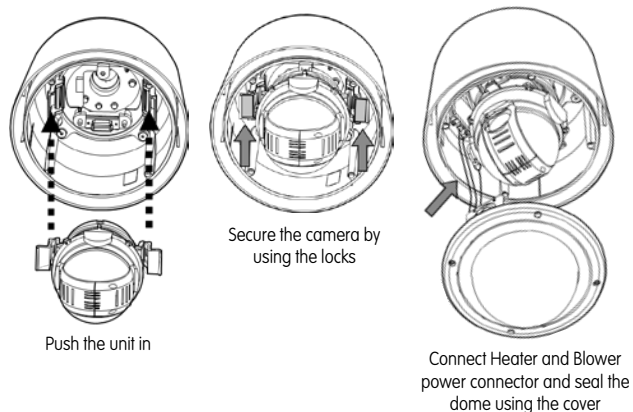

		PT 9637		
Camera	Signal Format	NTSC		
	Image Sensor	1/4" Double Density Interline Transfer CCD		
	Total Pixels	410K Pixels [811(H) x 508(V)]		
	Effective Pixels	380K Pixels [768(H) x 494(V)]		
	Horizontal Res.	Color: 550 TV Line / BW:620 TV Line		
	S/N Ratio	50 dB		
	Zoom	*37 Optical Zoom, *12 Digital Zoom (Max. *444)		
	Focal length	F1.6(W) 3.5(T) f=3.5~129.5mm		
	Min. illumination	Color: 1.0Lux/F1.6 (50IRE) B/W: 0.1Lux /F1.6 (50IRE)		
	Day & Night	Auto / Day / Night (ICR)		
	Focus	Auto / Manual / Semi-Auto		
	Iris	Auto / Manual		
	Shutter Speed	256 ~ 2, 1/60 ~ 1/120000 sec (27 Step)		
	AGC	Low/ Middle/ High/ Manual/ Off		
	White Balance	ATW/ AWC/ MANUAL/ INDOOR/ OUTDOOR (1,800K ~ 10,500K)		
	WDR, HLC	OFF/ WDR/ HLC		
Flickerless	Selectable			
DNR	LOW/ MIDDLE/ HIGH/ OFF			
Pan/Tilt	Range	Pan	360°(Endless)	
		Tilt	0~180°(Auto-Flip On) , 0°~ 95°(Auto-Flip Off)	
	Pan/Tilt Speed	Preset	360°/sec	
		Manual	0.05 ~ 360°/sec (proportional to zoom)	
		Auto Pan	1 ~ 180°/sec	
	Preset	127 Preset (Label, Camera Image Setting)		
	Pattern	4 Patterns, 1,000 commands/Pattern (about 5 minutes in Normal operation)		
	Scan	8 Scan		
	Group	8 Group (20 action entities per Group)		
	Schedule	7 Rules (Condition: Day, Time à Action: Preset, Scan, Group, Pattern)		
Other Functions	Freeze In Preset, Auto Flip, Auto Parking, Power Up Action etc..			
General	Communication	RS-485		
	Protocol	Auto, Pelco-D, Pelco-P, Samsung selectable		
	Privacy Zone	8 Zone		
	Alarm Input	8 Input		
	Alarm Output	4 Relay Output		
	OSD	Menu / PTZ information etc		
		Support 7 Languages		
	Rated Power	AC 24V	24W(Header OFF) / 57W(Header ON)	
	Dimension	Net (WH D)	260 * 552 * 405 mm, 10.2 * 21.7 * 16 inch	
		Package (WH D)	605 * 400 * 500 mm, 23.8 * 15.7 * 19.7 inch	
Weight	Net	about 6 kg, 13.2 Lb		
	Package	about 11 kg, 24.2 Lb		
Operating Temp.	-45°C ~ 50°C (-49°F ~ 122°F)			